

BRYSTON OWNER'S MANUAL

Instructions For Bryston

PowerPac 60/120

Monaural Amplifiers

GENERAL INSTRUCTIONS

General Information:

Thank you for choosing a Bryston product. We would welcome any comments or suggestions you may have regarding the operation of your amplifier. We consider our customer to be Bryston's most important resource and your opinion is very much appreciated.

In the unlikely event you have a problem with your amplifier and must return it for service please keep the original box and all packaging material.

The Bryston PowerPac 60/120 is a high quality modular single channel 60/120

watt power amplifier intended for use in applications where portability, quality and flexibility are of prime importance.

The PowerPac 60 or 120 is a perfect choice for use as a modular power amplifier which can be attached directly to the rear of your loudspeaker. It can also be bolted on the wall, or in the wall, for utilization in audio/video surround systems (left/right/center/rears) where a non-conspicuous power module is required. Another application would be in multi-room audio systems where single or multiple amplifiers are needed to provide music to other rooms.

Setup Recommendations:

We recommend that you do not place the amplifier in a totally enclosed area. Allow some space at the top, sides as your Bryston amplifier relies on convection cooling and some air flow is desirable.

Make sure the power switch on the front panel of the amplifier is in the off (out) position. Plug the power cord into the front panel of the amplifier, then insert the male end into the wall outlet.

All Bryston amplifiers contain high quality, dedicated circuitry in the power supplies to reject RF, line spikes and other power-line problems.

Bryston power amplifiers do not require specialized power line conditioners. Plug the amplifier directly into its own wall socket.

Connect your loudspeakers ensuring that the positive (red) and ground (black) terminals on your amplifier are connected to the positive and ground terminals on your loudspeakers.

Note:

Make sure that the front panel switch for choosing balanced or non-balanced is in the correct position.

Description:

The Bryston Powerpac 120 monaural amplifier consist of four of Bryston's custom power transistors as output devices. The power output is 120 Watts @ 8 Ohms, or 200 Watts @ 4 Ohms.

Dimensions: (LHW) 12 X 3.6 X 7.1 Inches
30.5 x 9 x 17.9 cm.
Weight 10 Lbs/4.5Kg.

The Bryston Powerpac 60 monaural amplifier consist of two of Bryston's custom power transistors as output devices. The power output is 60 Watts @ 8 Ohms, or 100 Watts @ 4 Ohms.

Dimensions: (LHW) - 12 X 1.8 X 7.1 Inches
30.5 x 4.6 x 17.9 cm.
Weight 5.7 Lbs/2.6Kg.

SPECIAL INSTRUCTIONS

POWERPAC 120 ONLY

The Powerpac 120 remote on/off function allows the user to link the power on/off of an amplifier, or group of amplifiers, to an external preamp, or other control product. This is useful in installations, such as home theater, which usually present a convenience problem for powering up multiple amplifiers, often at distant locations from the source.

Located on the left side of front panel of the Powerpac 120 (illustrated below), is a two terminal 12 volts (*active range 8 -19 volts AC or DC of either polarity*), input connector and a potentiometer.

Moving the potentiometer clockwise to any of the delay positions, (0 through 10 seconds), sets the remote - on/off function.

The power switch must be left in the "off" position, at all times for the amplifier to operate in this mode.

The amplifier can then be powered-up by an external 12-volt signal, connected to the terminals of the jack. (This jack will accept 1/4 -inch stripped wire ends, inserted into the square holes provided, and the adjacent screws carefully tightened to hold them in place. ***The amplifier will remain powered up while the 12-Volt signal is present, and will turn off when the 12-Volt signal is switched off.***

The "delay" function is provided to allow sequential power-up of multiple amplifiers in more complex systems. If the first clockwise position, (0), is selected on the potentiometer, the amplifier will turn on instantly upon application of the 12-Volt signal. Other positions , (between 0 and 10) , will give delays more than 0 and less than 10 seconds before power-up, following application of the 12-Volts. In this way groups of amplifiers may be sequenced ***on*** to distribute power surges over a period of time.

NOTE:

When powering the amplifier down remotely, you should wait at least "one minute" before restarting the system or resetting the power delay time. It takes some time for the capacitors in the delay circuit to discharge fully - (otherwise your delay setting will be incorrect).

NOTE:

If the input switch is in the wrong position (Balance/Unbalance) with respect to the input connector you are using, you will still have some output power from the amplifier but with lower level than nominal power.

BRYSTON

POWERPAC 60 MONAURAL AMPLIFIER

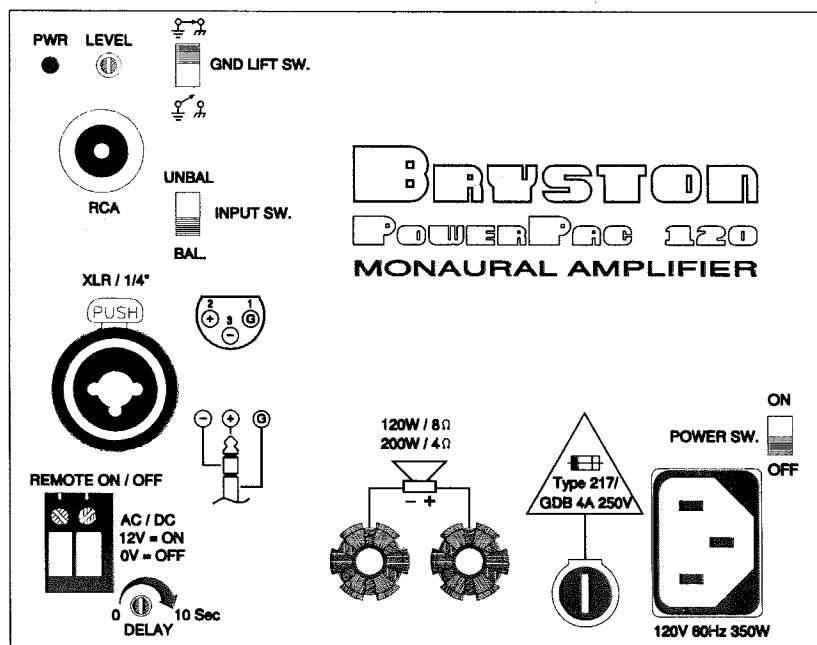
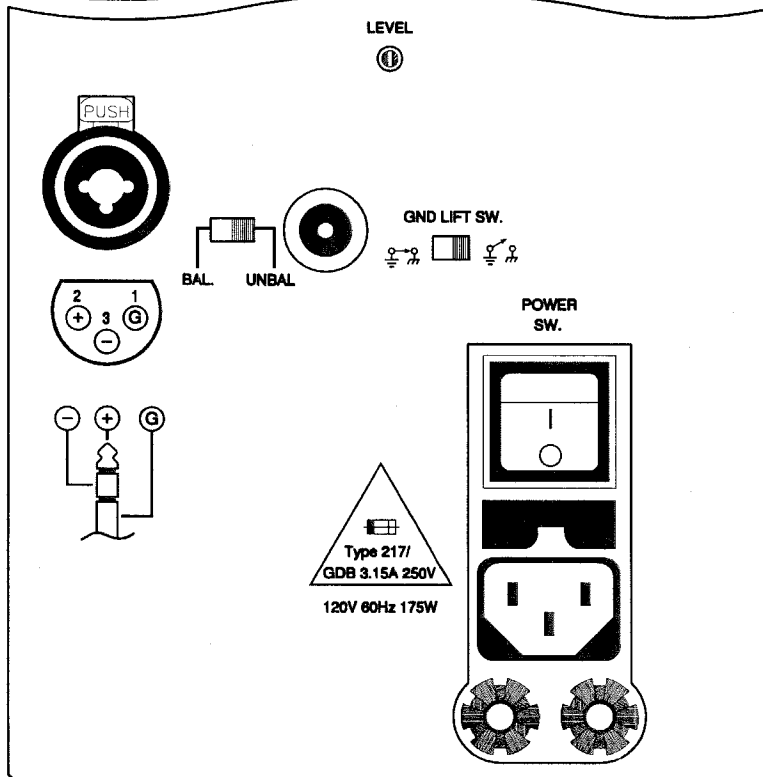

BRYSTON POWERPAC 60/120

Input and Output Connectors:

Bryston Powerpac amplifiers come standard with two input connectors: one unbalanced RCA/phono connector and a balanced combination XLR - 1/4-inch jack with fully discrete active input circuitry.

All input connectors are gold-plated and should only be used only with high-quality, gold-plated interconnect cable as a poorly plated connector will eventually corrode through the gold flash.

Bryston offers interconnect cables with heavily gold plated, quality connectors available through any Bryston authorized dealer or directly from Bryston.

Output connectors consist of one pair of five-way binding post terminals (1 red and 1 black) that can accept either standard banana plugs, spade lugs, pins or bare wire. Since the binding posts are gold-plated, we recommend gold plated connectors also be used on the speaker cables.

All Bryston amplifiers will accept balanced or single-ended (RCA) input connectors. The balanced inputs use combination 3-pin XLR (pin-1-ground), (pin-2-+) and 1/4-inch tip-(+), ring and sleeve (ground) input connectors.

Grounding and Ground Lift Switch:

A ground lift switch is located on the front panel of the amplifier. It is connected between the chassis ground (including the third prong on the power cord) and the signal ground.

This switch is normally left in the connected (up) position. Occasionally a multi-amplifier installation or an unusual grounding situation with another component (CD player, video recorder, television etc.) will cause a

ground loop between the signal ground and the chassis ground. This switch will reduce the resultant hum in many cases without resorting to a "cheater plug" by switching to the separated (down) position.

Note: this switch does not disconnect the chassis from the third prong on the power cord which must be left intact for safety reasons.

POWERPAC 60 ONLY

Dual colour LED pilot lights indicating GREEN at normal level, flashing RED at clipping.

BRYSTON 20-YEAR WARRANTY

Bryston products are warranted to be free from manufacturing defects for a minimum of twenty years from the original date of manufacture. This includes parts, labour and return shipping to the first owner and all subsequent owners. Warranty coverage is automatic and commences with the original date of manufacture which is kept on file at Bryston.

In the event of a defect or malfunction, Bryston will remedy the problem by repair or replacement, as we deem necessary, to restore the product to full performance.

This warranty is considered void if the defect, malfunction or failure of the product or any component part was caused by damage (not resulting from a defect or malfunction) or abuse while in the possession of the customer, tampering by persons other than factory-authorized service personnel, or failure to comply with Bryston operating instructions.

This warranty gives you specific legal rights and you may also have other rights which may vary from province to province and country to country.

**BRYSTON LTD.
P.O. BOX 2170
677 NEAL DRIVE
PETERBOROUGH, ONTARIO
CANADA.
K9J 7Y4.
PHONE: 705-742-5325
FAX: 705-742-0882**

- **BRYSTON SERVICE IN CANADA:
24 STEINWAY BLVD., UNIT 48
ETOBICOKE, ONTARIO
M9W 6T8
PHONE: 416-675-2585
FAX: 416-675-3103**

- **BRYSTON SERVICE IN UNITED STATES:
30 COVENTRY STREET,
NEWPORT, VERMONT.
05855
PHONE: 802-334-1201**